



PARADISE GRILLS®

Outdoor Refrigerator PGI-108-O

Operating Guide



**PGI-108-O Outdoor Refrigerator Operating Guide
April 2024**

The content of this manual is the property of Paradise Grills International, Inc. All rights reserved.
Any reproduction, in whole or in part, is strictly prohibited without express written consent
of Paradise Grills International, Inc.

Paradise Grills International, Inc.
640 Ocoee Business Pkwy, Suite #80
Ocoee, FL 34761

800-604-2023

www.paradisegrills.com
sales@paradisegrills.com

ATTENTION CONSUMER: PLEASE RETAIN THESE INSTRUCTIONS FOR FUTURE REFERENCE. You are responsible for checking updates and revisions available online at <https://paradisegrillsdirect.com/owners/>.

Purchase date _____



Contents

Safety Considerations	2
Safety Symbols.....	2
Operational Warnings.....	2
Overview	4
Features.....	4
Specifications.....	4
Components.....	5
Installation	6
Location	6
Getting Started	7
Level the Unit.....	7
Operating the Refrigerator	8
Control Panel	8
Turn the Refrigerator On.....	8
Turn the Refrigerator Off.....	9
Lock the Door	9
Energy Saving Tips.....	9
Cleaning and Maintenance	10
Cleaning the Refrigerator.....	10
Defrost the Refrigerator.....	10
Reverse the Refrigerator Door.....	11
Troubleshooting	12
Limited Manufacturer’s Warranty	14
Limited Warranty	14
Warranty Claim Submission	15

Safety Considerations

Safety Symbols

Throughout this manual, important safety information will be highlighted and marked as **CAUTION**, **DANGER**, or **WARNING**.

	A potentially hazardous situation or unsafe practice which, if not avoided, may result in minor or moderate injury, or property damage.
	A potentially hazardous situation which, if not avoided, could result in death or serious injury, or property damage.
	An imminently hazardous situation which, if not avoided, will result in death or serious injury, or property damage.

Operational Warnings

All users must read this entire manual before attempting to operate the accessory. Do not use appliance for other than intended use. Follow these safety precautions every time the accessory is used:

Keep ventilation openings, in the appliance enclosure or in the built-in structure, clear of obstruction.
This appliance contains flammable refrigerant R600a. Avoid contact with fire when transporting and using it.
Ensure the power supply cord is not damaged or routed under the cooler.
Do not damage the refrigerant circuit.

Do not store explosive substances such as aerosol cans with a flammable propellant in this appliance.
Do not install the unit where the appliance will come in contact with water or excessive moisture to avoid electrical hazard and rusting of metal parts.
Position the refrigerator away from any combustible materials such as gas, alcohol, lacquer, etc. Do not store such objects in the refrigerator under any circumstances.
Risk of Fire or Explosion. Flammable refrigerant used – dispose of properly in accordance with the applicable federal or local regulations.
<p>CALIFORNIA PROPOSITION 65</p> <ul style="list-style-type: none"> • Combustible by-products produced when using this appliance contains chemicals known to the State of California to cause cancer, birth defects, or other reproductive harm. • This product contains chemicals, including lead and lead compounds, known to the State of California to cause cancer, birth defects or other reproductive harm. • For more information see www.P65Warnings.ca.gov.

Read this manual thoroughly before using this equipment to reduce risk of injury.
This appliance should not used by children or persons with reduced physical, sensory or mental capabilities or lack of experience and knowledge. Children should not play with the appliance.
Cleaning and user maintenance shall not be done by children without supervision.
To avoid a hazard, a damaged power supply cord must be replaced by the manufacturer, its service agent, or similarly qualified persons.
Ensure the power plug is accessible. If extension cord is necessary, use minimum 18 AWG size rated at no less than 1875 watts.
This appliance is designed for storing and cooling beverage or wines. Do not store perishable food, medicine or other medical products.
Power supply must be properly grounded. Do not remove the ground prong from the appliance plug.
Never unplug the unit by pulling on the wire. Firmly grasp the plug and pull it straight out from the outlet.
All repairs should be made by a qualified service technician. Repairs made by non-qualified personnel will void the warranty.

Overview

Features

- 3.8 cu ft of cold storage
- Reversible door handle for easy opening on either side
- Shelves glide smoothly in and out of cabinet to provide easy access for stocking and retrieving product
- UV-resistant tinted dual pane glass door protects contents from damaging ultraviolet light and helps conserve energy
- Cool Blue LED lighting brightly illuminates interior for better viewing day or night
- Energy efficient, quiet operation
- Adjustable legs for leveling on any surface
- Multifunction controls allows selection of precise cabinet temperature from 32°F to 50° F

Specifications

Product description	Outdoor refrigerator		
Model number	PGI-108-O		
Capacity	108 L/3.8 cu. Ft.		
Electrical rating	115V/60Hz/1.1A		
Refrigerant	R600a, 0.88 oz/25g		
Unit dimensions with feet	Width	Depth	Height
	20.28" (515 mm)	23.03" (585 mm)	31.5" (800 mm)
Net weight	91.5 lbs		

Components

1. Control panel
2. Removable shelves
3. Hot air outlet
4. Door lock
5. Adjustable feet
6. Glass door
7. Door handle (assembly required)

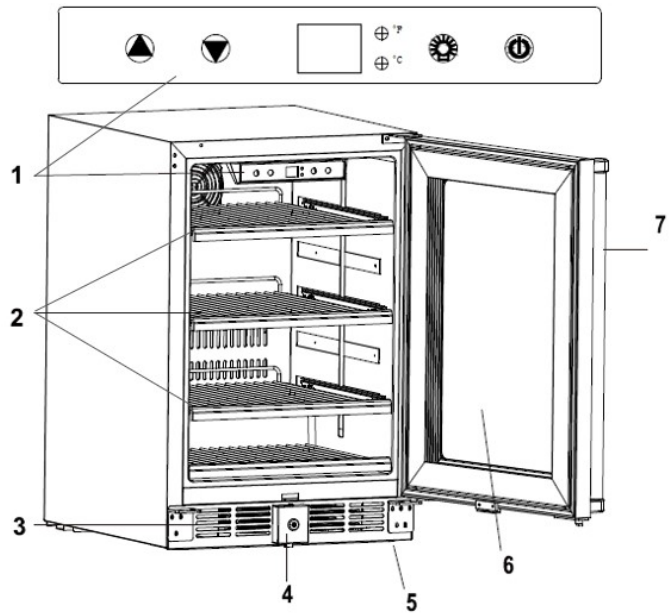

Figure 1 Refrigerator Components

Installation

Location

This appliance can stand alone or be built in. The front grille must not be obstructed.

- Place appliance on a level surface that is strong enough to support the unit when it is fully loaded
- Ensure at least 2" (255 mm) of space between the back and sides of the unit to allow proper air circulation to cool the compressor and condenser
- If the appliance is installed into an island, ensure proper clearance and ventilation, and do not cover the unit with a door; sample island installation shown in Figure 2

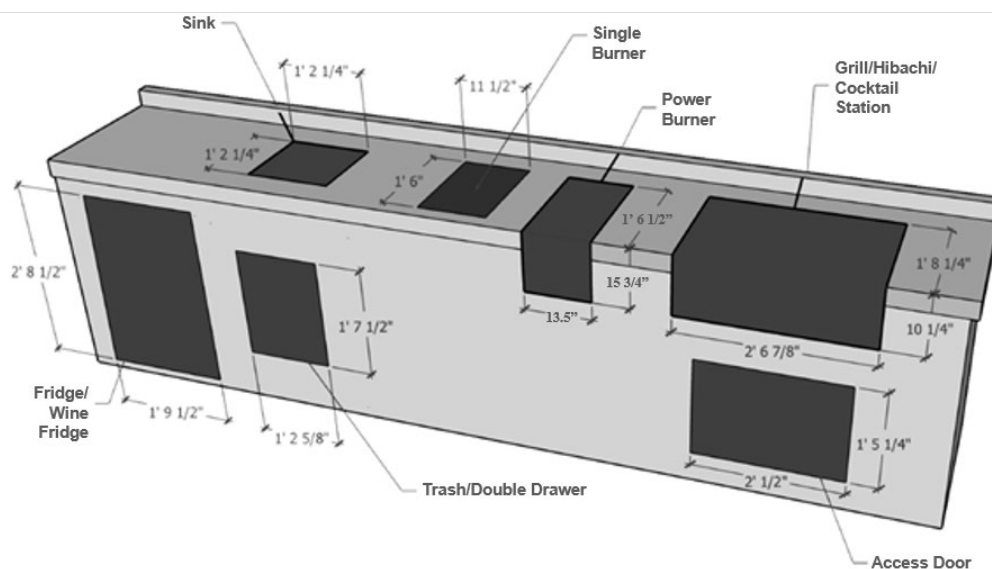

Figure 2 Sample Island Setup

- Do not place the unit in direct sunlight or other sources of heat (stove, heater, radiator, etc.)
- Direct sunlight may affect the acrylic coating, and heat sources may reduce performance and increase electrical consumption
- Extreme cold ambient temperatures may also reduce performance
- Avoid locating the unit in areas of excessive moisture

Getting Started

- Carefully handle the appliance to avoid any damage.
- Keep the refrigerator upright when moving it; never tilt the appliance beyond 45° or place the unit in an upside-down position
- If the refrigerator has been placed in a horizontal or tilted position for any period of time, place it upright and level, and wait 24 hours before plugging it in
- Allow the unit to stand upright for 4 hours before plugging it in to allow the cooling system to stabilize, which will reduce the possibility of a malfunction due to handling
- Remove the exterior and interior packing.
- Clean the unit thoroughly before putting it into use; wipe the outside with a soft dry cloth, and the interior with a clean moist cloth
- When installed, ensure the door can be opened completely – approximately 160° of travel

Level the Unit

Set the adjustable legs at the front corners of the refrigerator so the refrigerator is firmly positioned on the floor with the front raised just enough that the door closes easily when opened about halfway.

To adjust the leveling legs, rotate each leg counterclockwise to raise the leg, and clockwise to lower it. Adjust legs until the unit is level.

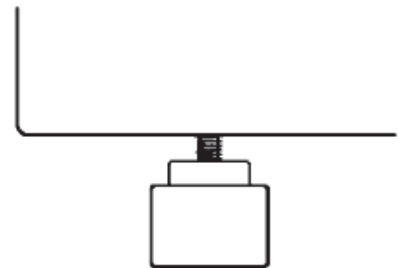

Operating the Refrigerator

Control Panel

The control panel is located at the top of the unit inside the door, and includes these touch buttons and indications:

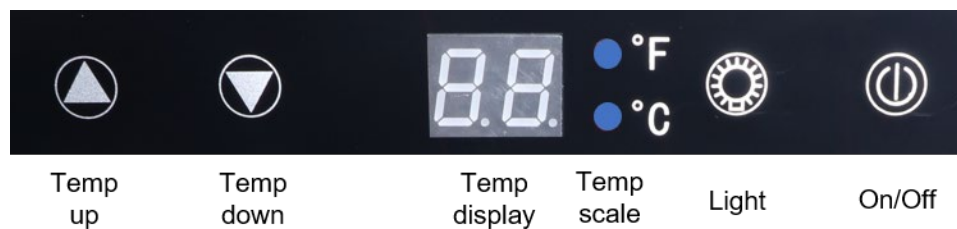

Figure 3 Control panel

- Temp up/down – touch to adjust the unit temperature:
 - Each press changes the temperature 1°F
 - Setting range is 32 - 50°F
 - Default setting is 39°F
- Temp display – shows the current unit temperature; momentarily flashes the new temperature when changing the setting
- Temp scale – a blue light indicates the selected temperature scale in degrees Fahrenheit or Celsius; to select a scale, touch and hold the temp down button for 3 seconds until the scale changes
- Light – an LED light inside the unit turns on when the door is opened, and turns off when the door is closed; to change the door light operation:
 - disable the light – touch and hold the light button for 3 seconds
 - re-enable the light – touch and hold the light button for 3 seconds
- On/Off – apply power to the unit:
 - Touch momentarily to turn the unit on
 - Touch and hold for 3 seconds to turn the unit off

Turn the Refrigerator On

1. Plug the refrigerator into a grounded outlet.
2. Touch the On/Off button on the control panel; default temperature setting is 39°F
3. Allow the unit to run for at least 2 hours to ensure the cabinet is chilled before adding food
4. Adjust the temperature setting to reach the desired coolness

Turn the Refrigerator Off

If the refrigerator will not be used for a prolonged period:

1. Touch the On/Off button for 3 seconds to turn the unit OFF.
2. Remove all contents.
3. Unplug the unit, clean and dry the interior, and leave the door open for a few days.

NOTE: If the refrigerator is unplugged, wait 3-5 minutes before restarting. If restarted too quickly the unit may fail to properly operate.

NOTE: Turning the unit OFF stops the cooling cycle, but does not disconnect the refrigerator power supply.

Lock the Door

The door may be locked closed using a key provided with the unit. To lock, ensure the door is fully closed and Insert the key to the lock at the center of the bottom grille (below left), and turn clockwise. Rotate the key counterclockwise to unlock the door. Keep the key in a safe place.

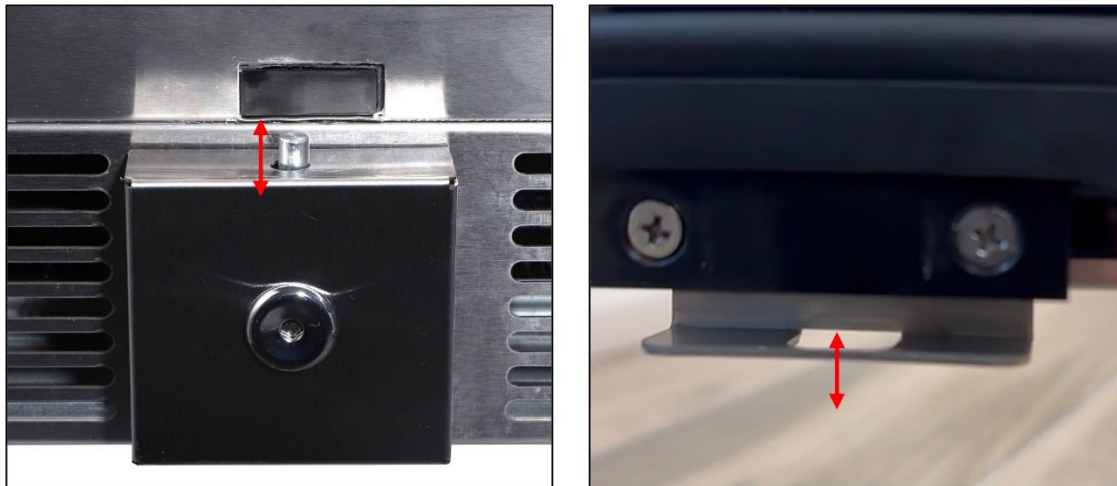

Figure 4 Locking the Door

Energy Saving Tips

- Locate the unit in the coolest area, away from direct sunlight or heat producing appliances
- Keep the refrigerator door fully closed as much as possible, particularly in warm/humid conditions
- Ensure there is adequate ventilation around the back and sides of the unit
- Allow warm food or beverages to cool to room temperature before placing in the refrigerator
- Do not obstruct the front hot air outlet

Cleaning and Maintenance

Cleaning the Refrigerator



Unplug the unit before cleaning or maintenance.

Do not submerge the unit or allow water to run down the sides of the cabinet, which will allow the electrical components to get wet.

Never use flammable fluids; harsh, abrasive cleaners; heavy-duty cleaners; or solvents.

Clean the refrigerator as follows:

1. Unplug the appliance, remove all contents, and store them in a suitable place.
2. Exterior: Wipe with damp, sudsy cloth, rinse and dry. Use silicon wax for stubborn stains and for periodic waxing.
3. Refrigeration Section: Wash shelves and other removable parts in warm sudsy water, rinse and dry. Wash interior with baking soda solution (3 tablespoons to 1 liter of water) or warm sudsy water, rinse and dry.
4. Magnetic Door Seals: Wash with warm sudsy water.
5. Replace all parts and return thermostat dial to desired setting on any surface.

Defrost the Refrigerator

Ice can form in refrigerators when moist air enters the appliance in the cooling cycle, condenses, and forms ice on the back wall. If the ice is left for a long time it can cause your wine to freeze, and the unit could eventually stop working.

To defrost, remove all items, unplug the refrigerator, leave the door open, and wait for the ice to melt and drain. Do not use mechanical means such as a hair dryer, or a metal tool to scrape the frost. When the ice is clear, clean and dry the inside of the unit, plug it in, and restart operation.

Reverse the Refrigerator Door

Follow these steps to reverse the door if desired:

1. Unplug the refrigerator and remove any contents.
2. Carefully lay the refrigerator on its back (Figure 5).

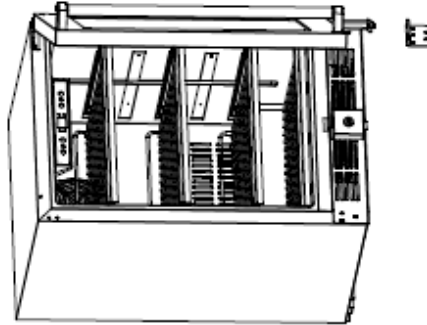

Figure 5 Lay the unit on its back

3. Remove lower hinge retaining plate and carefully remove the door.
4. Remove the right upper hinge; secure the left upper hinge in the accessory back in the upper right corner of the cabinet.
5. Remove the door handle, then secure the handle to the right side of the door.
6. Remove the automatic reset from the door lower right corner and move it to the door lower left corner.
7. Install the door to the upper left hinge, and install the lower hinge to hold it in place.

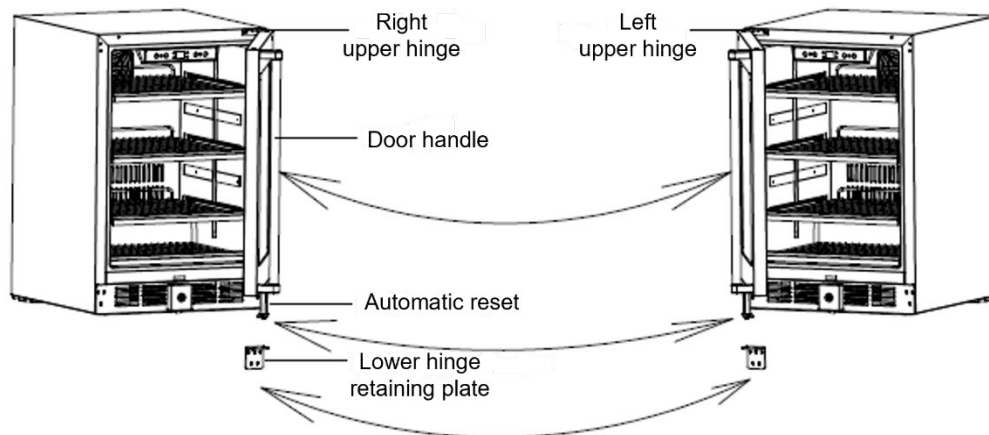

Figure 6 Door reversal

8. Raise the refrigerator to an upright position.
9. Check that door and cabinet are properly aligned and tighten all screws; check normal door operation and adjust door position if needed.
10. Wait 24 hours and repeat the [Operating the Refrigerator](#) process to resume operation.

Troubleshooting

This refrigerator has no user replaceable components. However, many common problems can be easily solved. Try the suggestions below to resolve the problem before calling a service provider.

Problem	Possible Cause	Possible Actions
Unit does not operate	<ul style="list-style-type: none"> Not plugged in Circuit breaker is tripped or fuse is blown 	<ul style="list-style-type: none"> Ensure unit is correctly plugged in Check circuit breaker or fuse, and reset or replace if needed
Unit is too warm inside	<ul style="list-style-type: none"> Door is ajar or door seal is damaged Unit is overfilled Clearance around unit is blocked 	<ul style="list-style-type: none"> Ensure door closes properly and seal is not damaged Remove enough items to allow proper cooling circulation Remove any obstacles blocking air movement around all sides of the unit
Drip tray overflows	<ul style="list-style-type: none"> Drain pipe and hose are clogged Drain pan is improperly installed 	<ul style="list-style-type: none"> Ensure drain pipe and hose are clear Ensure drain pan is properly installed
Cabinet front warms up	<ul style="list-style-type: none"> Front of unit cabinet feels warm 	<ul style="list-style-type: none"> Not a malfunction; indicates proper action of anti-condensation system
Unit turns off and on frequently	<ul style="list-style-type: none"> The room temperature is hotter than normal A large number of warm bottles have been added to the unit The door is opened too often The door is not closed completely The temperature control is not set correctly The door gasket does not seal properly The unit does not have the correct clearances 	<ul style="list-style-type: none"> Cool the room if possible Avoid overloading the cooler Ensure door is kept closed and sealed Keep the door gasket clean Ensure nothing blocks the door from closing completely Ensure temperature control is set to the desired range Ensure minimum clearance space around and below the unit is maintained
Vibrations	<ul style="list-style-type: none"> Unit is tilted slightly. 	<ul style="list-style-type: none"> Ensure the unit is level.
Condensation forms on cabinet	<ul style="list-style-type: none"> High humidity 	<ul style="list-style-type: none"> Not a failure; wipe dry with a clean cloth
Unit makes unusual noises	<ul style="list-style-type: none"> Is unit wobbly? Have objects fallen behind unit? 	<ul style="list-style-type: none"> Re-level the unit Remove items

Unit makes too much noise	<ul style="list-style-type: none"> • The rattling noise may come from the flow of the refrigerant, which is normal • As each cycle ends, you may hear gurgling sounds caused by the flow of refrigerant in your unit. • Contraction and expansion of the inside walls may cause popping and cracking noise • The unit is not level 	<ul style="list-style-type: none"> • Some noises are the natural result of the cooling system • Ensure unit is level
Door doesn't close properly	<ul style="list-style-type: none"> • The unit is tilted • The door was reversed and not properly installed • The gasket is dirty or bent • The shelves, bins, or baskets are out of position 	<ul style="list-style-type: none"> • Ensure unit is level • Check door for proper installation • Clean the gasket and replace if a bend stops door from closing • Reposition interior shelves, bins, and baskets as needed
Ice/frost forms inside the unit	<ul style="list-style-type: none"> • High humidity • Door is not kept closed • Door seal is faulty • Unit is overloaded • Frequent opening of door 	<ul style="list-style-type: none"> • Defrost as needed • Ensure door is fully closed • Replace faulty door seal • Remove excess bottles • Keep door closed in high humidity

Responsibly dispose or recycle this unit through public collection points to avoid environmental harm. Remove the doors before disposal to avoid child entrapment.

Limited Manufacturer's Warranty

Limited Warranty

PGI warrants to the original purchaser that the product will be free from defects in material, parts, and workmanship for the period designated for this product. The warranty commences the day the product is purchased and covers up to a period of:

- 1 year (12 months) for labor
- 1 year (12 months) for parts (manufacturing defects only)/carry in service
- A total of 2 years (24 months) for compressor parts only

PGI agrees that it will, at its option, replace the defective product with either a new or remanufactured unit equivalent to your original purchase during the warranty period.

Exclusions: This warranty does not apply:

1. If the appearance or exterior of the product has been damaged or defaced, altered, or modified in design or construction
2. If the product original serial number has been altered or removed or cannot be readily determined
3. If there is damage due to power line surge, user damage to the AC power cord, or connection to improper voltage source
4. If damage is due to general misuse, accidents, or acts of God
5. If repair attempts are done by unauthorized service agents, use of parts other than genuine parts, or parts obtained from persons other than authorized service companies
6. On units that have been transferred from the original owner
7. On products that have been purchased as refurbished, like new, secondhand, in an "As-Is" or "Final Sale" terms
8. To products using a commercial or rental setting
9. To products used in settings other than ordinary household use, or use other than in accordance with the provided instructions
10. To damages for service calls for improper installations
11. To glass parts and other accessory items that are included with the unit
12. To transportation and shipping costs associated with the replacement of the unit
13. To food loss for loss due to product failure or delay in service repair or replacement
14. To service calls to instruct you how to use your product

15. To service calls to repair or replace a fuse, reset a circuit breaker, or correct wiring in the house REPAIR OR REPLACEMENT AS PROVIDED UNDER THIS WARRANTY IS THE EXCLUSIVE REMEDY OF THE CUSTOMER; PARADISE GRILLS INTERNATIONAL SHALL NOT BE LIABLE FOR ANY INCIDENTAL OR CONSEQUENTIAL DAMAGES FOR BREACH OF ANY EXPRESS OR IMPLIED WARRANTY ON THIS PRODUCT, EXCEPT TO THE EXTENT PROHIBITED BY APPLICABLE LAW. ANY IMPLIED WARRANTY OF MERCHANTABILITY OF FITNESS FOR A PARTICULAR PURPOSE ON THIS PRODUCT IS LIMITED TO THE DURATION OF THE WARRANTY.

Some states do not allow the exclusion or limitations of incidental or consequential damages, or limitations on how long the warranty lasts. In these cases the above exclusions for limitations may not apply to you. This warranty gives you specific legal rights and you may also have other rights which vary from state to state.

Obtaining service: To obtain service, product literature, supplies, or accessories please call **1 (800) 604-2023** to create a ticket for the exchange/repair. Please make sure to provide the date of purchase, model number, and a brief description of the problem. A customer service representative will contact you or send detailed return instructions.

Paradise Grills International does not warrant that the appliance will work properly in all environmental conditions, and makes no warranty and representation, either implied or expressed, with respect to the quality, performance, merchantability, or fitness for a particular purpose other than the purpose identified within this operating guide. PGI has made every effort to ensure that this operating guide is accurate and disclaims liability for any inaccuracies or omissions that may have occurred. Information in this operating guide is subject to change without notice and does not represent a commitment on the part of PGI. Paradise Grills International reserves the right to make improvements to this operating guide and/or to the products described in this operating guide at any time without notice. If you find information in this manual that is incorrect, misleading, or incomplete please contact us at **1 (800) 604-2023**.

Warranty Claim Submission

The ORIGINAL PURCHASER must submit to Paradise Grills International, Inc. a warranty claim within five (5) business days of date such claim is or should have been discovered, or else such claim is forever waived and barred.

To submit a warranty claim, the ORIGINAL PURCHASER must submit a written description and photographs detailing the appliance's damage or defect(s), along with a complete copy of the Final Sales Agreement either:

- (i) via email to Warranty.Claim@paradisegrills.com; or
- (ii) via U.S. mail to Paradise Grills International, Inc., Attn: Warranty Claim, 640 Ocoee Business Parkway, Suite 80, Ocoee, Florida 34761.

For more information, please call Paradise Grills International, Inc. at 800-604-2023.